



PROJECT HIGHLIGHT

SHANGRI-LA PHNOM PENH

CAMBODIA

Escape to Shangri-La Phnom Penh, a waterfront sanctuary where exceptional Asian hospitality seamlessly blends with Khmer influences. The hotel, designed in a sophisticated French art déco style, offers stunning views of the city and the Mekong River. Renowned for its dining experiences, Shangri-La Phnom Penh features Altitude, Cambodia's highest sky bar and Shang Palace, a 50 year old Chinese culinary heritage brand. Guests will be treated to sky-high experiences at one of Cambodia's tallest waterfront landmarks, while immersing themselves in a space that celebrates both the community and the rich Khmer culture. Conveniently located near key attractions, government offices, embassies, and the iconic Koh Pich "Diamond" island.

[LEARN MORE](#)



Ground Floor Lobby

Shangri-La Phnom Penh embodies refined luxury, blending Cambodian culture with world-class hospitality. Thoughtfully designed by Avalon Collective and Socialight, the Ground Floor Lobby features warm, elegant lighting that enhances intricate décor, creating a sophisticated yet welcoming ambience.





Sky Lobby

The lighting design at Shangri-La Phnom Penh blends grandeur with tranquility, enhancing the entire guest experience. Exquisitely curated lighting accents highlight architectural features, creating a chic ambience that transitions seamlessly from day to night, ensuring a luxurious and exclusive atmosphere.



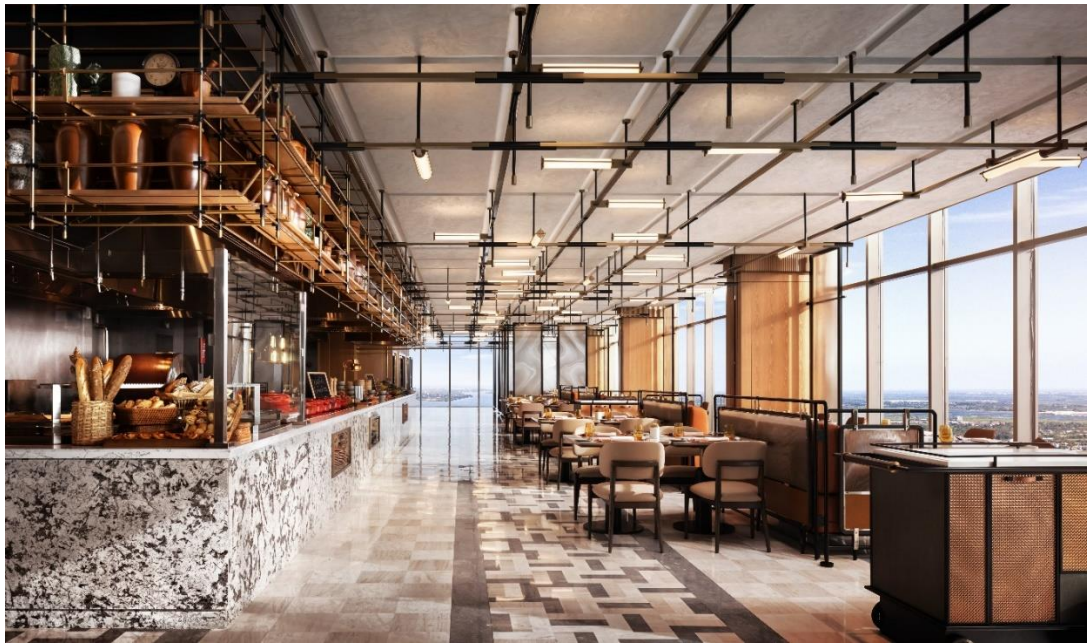

Kommune

The Kommune Dining Area exhibits layered and dynamic lighting, adding warmth and elegance to every meal. Designed to adapt to different moods, the lighting complements the luxurious interiors and completes the full dining experience.





The Atelier

The Atelier beams a warm and focused lighting that showcases exquisite pastries. The accent lighting brings out the textures and details, creating an indulgent atmosphere that highlights the artistry and craftsmanship of each treat.





Deluxe King City View Room

The lighting design at Shangri-La Phnom Penh blends grandeur with tranquillity, complementing the entire guest experience. Thoughtfully curated lighting accents highlight architectural features, creating a tranquil ambience that transports the guests to an unforgettable restful stay.

SCOPE OF WORK : ARCHITECTURAL & DECORATIVE LIGHTING

CLIENT : OXLEY GEM (CAMBODIA)

INTERIOR DESIGNER: : AVALON COLLECTIVE

LIGHTING CONSULTANT: SOCIALIGHT

PROJECT DATE : 2024

COUNTRY : CAMBODIA

Introducing the

Million Lighting Company Profile

[View the Company Profile](#)

